

Manual

Back Up Kit Re Liable One 600

600135 • 07/2016



General safety instructions

- Solar modules generate electricity in low incidence of light too! Cover the solar panel and work carefully!
- Make sure that the installation of the solar charge controller takes place in a stable, flat and dry environment. Please note to keep a distance of 15 cm around the unit!
- Danger of explosion due to improper handling of batteries! Danger of receiving an acid burn through the battery acid! Keep children away from batteries and acid!
- Please note the operating instructions of the solar charge controller, the solar module and the battery as well!
- When connecting the cables, make sure the polarity is correct! All work must be carried out in compliance with the national provisions and the local regulations!
- Do not use defective components and keep the intended use of the system!

For the installation you need well isolated tools:



■ Phillips screwdriver



■ small screwdriver



■ pliers



■ carpet knife

Prepare circuit breaker

- DC circuit breaker
- Terminal clamp for bipolar circuit breaker
- Distribution box
- Cable gland
- Cable gland nut
- Cable
- Wire end
- Ring terminals

Step 1

Cut the cable in (1 x 16,0 mm²) in three pieces. One piece of the cable leads from the battery to the circuit breaker, another cable leads from the battery into the inverter. Lead the remaining cable from the circuit breaker into the inverter.

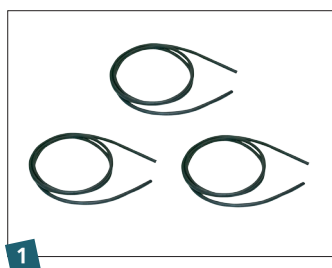

1

Step 2

Remove a piece of the coating on the ends and strip 10 mm of the wire insulation.

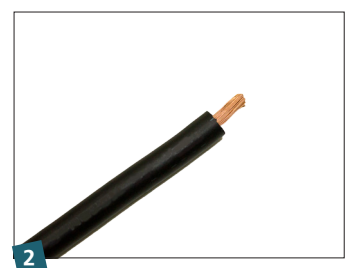

2

Step 3

Fix a wire end at one end each of two cables (1 x 16,0 mm²) and a ring terminal on the other end.

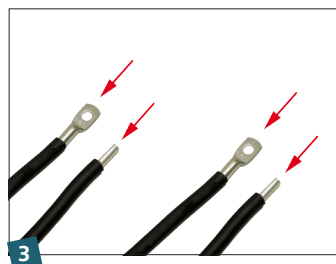
**Step 4**

Use the remaining piece of the cable and fix a ring terminal on both ends.

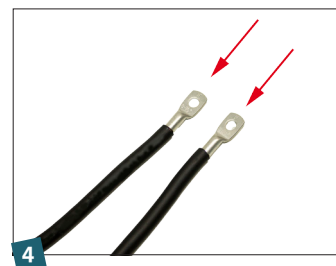
**Step 5**

Open the enclosure and insert the circuit breaker. Loosen the two soft membranes and fix the cable glands with the help of the two nuts.

**Step 6**

Use a cable with wire end and ring terminal. Slip the seal and cable gland on the cable and lead the wire end into the enclosure. Screw the wire end at the circuit breaker.

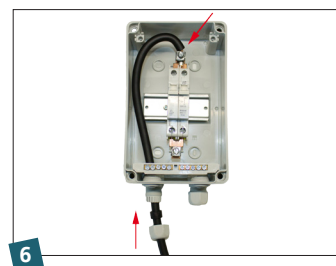
**Step 7**

Use the second cable with wire end and ring terminal. Slip the seal and cable gland on the cable and lead the wire end into the enclosure. Tighten the wire end at the circuit breaker. Close the circuit breaker.

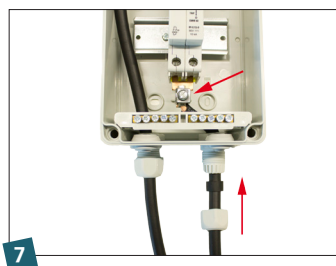

Connect cable with inverter

- Inverter
- AC-Cable

Step 8

Follow the installation steps of the Quick Installation Guide of the inverter.

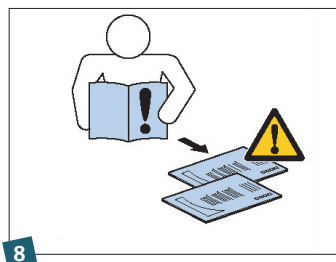

Step 9

The inverter is delivered with fixed battery cables. Do not place the inverter above the batteries! Connect the inverter with the ground.

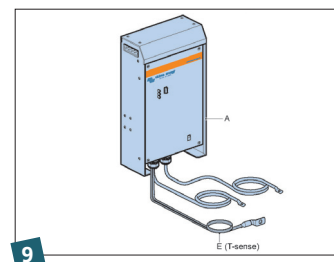

Step 10

Tighten the ring terminals to the respective contacts of the battery, add the ring terminal of the temperature sensor to the minus terminal of the battery, too.

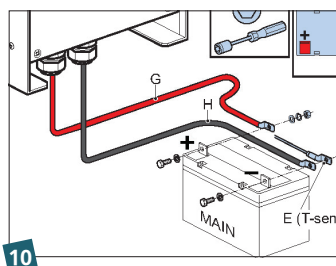

Step 11

Fix the AC-cables inside the plugs and plug in them into the AC-output.

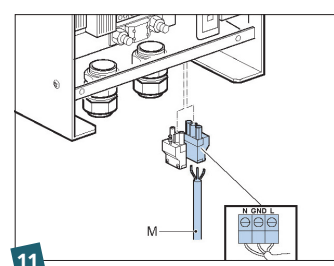

Connect cable with battery

- Battery

12. Schritt

Untighten the screws at the battery terminals. Screw the cable ring terminal that leads into the circuit breaker to the positive battery terminal and the other ring terminal to the negative battery terminal.

