

Modular MEGA fuse holder and high current busbar

www.victronenergy.com

Dovetail feature

The dovetail feature allows interlocking multiple fuse holders.

Five position high current bus bar (500 A)

With one M10 input connection.
Input current up to 500 A.

Six position high current bus bar (1500 A)

With two M10 input connections.
Input current up to 2000 A.
Recommended to parallel multiple high power Multi or Quattro inverterchargers.

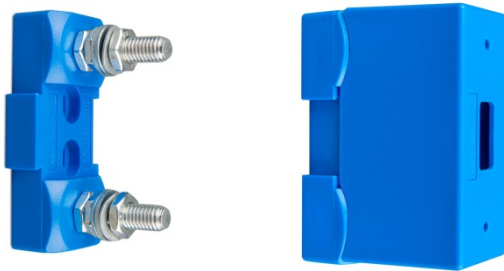

Single fuse holder without cap and with cap

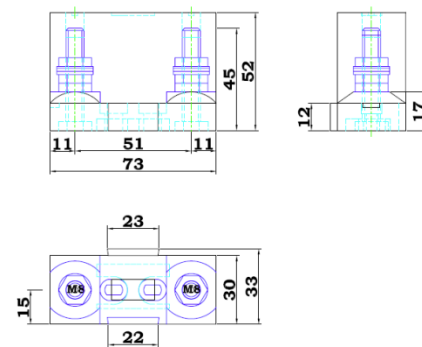

CIP100200100 = Modular fuse holder for Mega-fuse



Stacked fuse holders with 5-position high current bus bar (copper 40 x 5 mm)

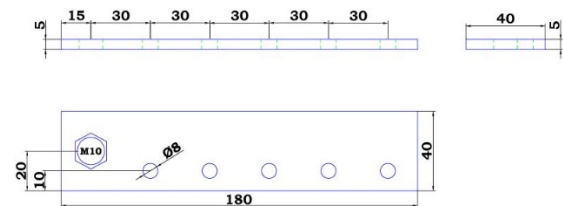

CIP100400060 = Busbar to connect 5 CIP100200100



Stacked fuse holders with 6-position high current bus bar (copper 40 x 5 mm)

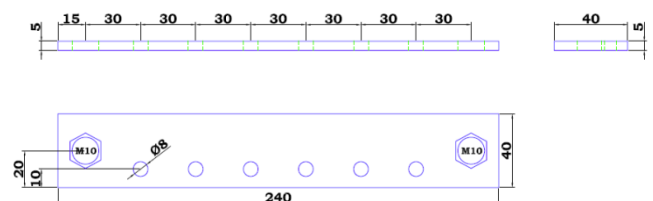

CIP100400070 = Busbar to connect 6 CIP100200100