



**ALPHA
OUTBACK
ENERGY**

Models:

SPC III 1500-24

SPC III 4000-24

SPC III 6000-48



SPC III

Solar Off Grid-Hybrid Inverters

Features

- ⊕ Output Power Factor 1
- ⊕ Built-in MPPT Charge Controller
- ⊕ PV Array Open Circuit Voltage up to 500VDC
- ⊕ Up to 6000W PV Array Power
- ⊕ Detachable LCD control module with various communications. Can be turned to remote panel.
- ⊕ Built-in WiFi or Bluetooth for mobile monitoring (App is available)
- ⊕ Reserved communication port for BMS (RS485, CAN-BUS or RS232)
- ⊕ Lithium-ion battery compatibility
- ⊕ Replaceable fan design for ease of maintenance
- ⊕ Battery Independency: Supply load from Grid or PV, even battery is not available
- ⊕ Configurable AC/PV output usage timer and prioritization
- ⊕ Selectable high power charging current
- ⊕ Selectable input voltage range for home appliances and personal computers
- ⊕ Compatible to Utility Mains or generator input
- ⊕ Auto restart while AC is recovering
- ⊕ Cold start function when grid is not available

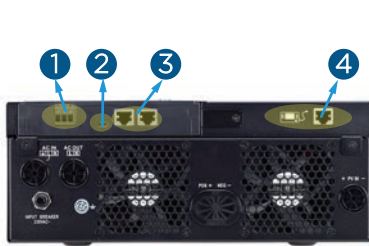

1 Dry contact



2 USB On-the-Go function



3 Reserved communication port

(RS-485, CAN-BUS or RS-232) for BMS



4 Communication for Remote panel

Energy-MATE App*
Android and iOS



*For SPCIII 1500-24 WiFi-S is needed

With battery connected

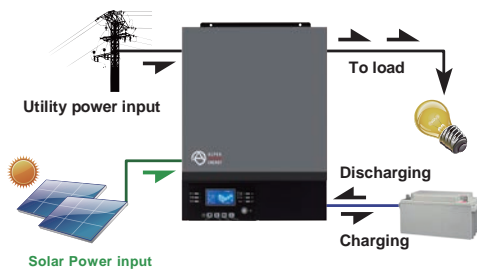

Without battery connected

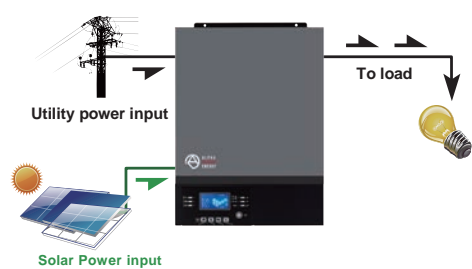



ALPHA OUTBACK ENERGY



MODEL	SPCIII-1500-24	SPC III 4000-24	SPC III 6000-48
Rated Power	1500VA/1500W	4000VA/4000W	6000VA/6000W

INPUT			
Voltage	230Vac		
Selectable Voltage Range	170-280 VAC (For Personal Computers) ; 90-280 VAC (For Home Appliances)		
Frequency Range	50 Hz/60 Hz (Auto sensing)		

OUTPUT			
AC Voltage Regulation (Batt. Mode)	230Vac +/- 10%		
Surge Power	3000VA	8000VA	12000VA
Efficiency (Peak)	93%		
Transfer Time	15 ms (For Personal Computers) ; 20 ms (For Home Appliances)		
Waveform	Pure sine wave		

BATTERY			
Battery Voltage	24 Vdc	24 Vdc	48 Vdc
Floating Charge Voltage	27 Vdc	27 Vdc	54 Vdc
Overcharge Protection	33 Vdc	33 Vdc	63 Vdc

SOLAR CHARGER & AC CHARGER			
Solar Charger Type	MPPT		
Maximum PV Array Power	2000W	5000W	6000 W
MPP Range @ Operating Voltage	120 - 380 VDC	120 - 450 VDC	120 - 450 VDC
Maximum PV Array Open Circuit Voltage	400 VDC	500 VDC	500 VDC
Maximum Solar Charge Current	60A	120A	120A
Maximum AC Charge Current	40A	100A	100A
Maximum Charge Current	60A	120A	120A

PHYSICAL			
Dimension, D x W x H (mm)	100 x 280 x 390	115 x 300 x 400	115 x 300 x 400
Net Weight (kgs)	8.5	9	10
Communication Interface	USB/RS232/RS485/Bluetooth/Dry-contact		USB/RS232/RS485/WiFi/Dry-contact

ENVIRONMENT			
Humidity	5% to 95% Relative Humidity (Non-condensing)		
Operating Temperature	-10°C to 50°C		
Storage Temperature	-15°C to 60°C		

All information contained in this document is subject to change without notice.



Worldwide Corporate Offices

Headquarter Germany

Hansastraße 8
D-91126 Schwabach
Tel: +49 9122 79889 0

Email: info@alpha-outback-energy.com

Eastern Europe

ee@alpha-outback-energy.com

Middle East

me@alpha-outback-energy.com

France and Benelux

fbnl@alpha-outback-energy.com

Spain

spain@alpha-outback-energy.com

Africa

africa@alpha-outback-energy.com

Alpha and Outback Energy GmbH reserves the right to make changes to the products and information contained in this document without notice. Copyright © 2020 Alpha and Outback Energy GmbH. All Rights reserved.

For more information, please visit www.alpha-outback-energy.com

