

SPCIIIS-5000-48 - Solar Off Grid-Hybrid Inverter

Features

- 5000 Watts pure sine wave Solar Inverter/charger
- Built-in MPPT Charge Controller 100A
- PV Array Open Circuit Voltage up to 450VDC
- Up to 5000W PV Array Power
- Paralell operation up to 9 units, no need extra paralell card.
- Detachable LCD module usable as remotely wired control panel (up to 20 m)
- Integrated Bluetooth for mobile monitoring (Android)
- Reserved communication port for BMS (RS485, CAN-BUS or RS232)
- Lithium-ion battery compatibility
- Battery Independency: Supply load from Grid or PV, even without battery (single unit only)
- Configurable AC/PV output usage timer and prioritization
- Selectable high power charging current
- GPRS module (box version), WIFI box and WIFI stick available for remote monitoring

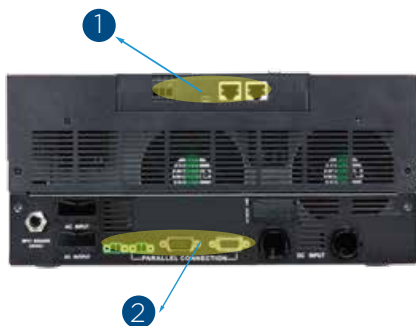

- Diverse communications:**
- 1 RS485/USB Port and Dry contact communication
 - 2 Maximum 9 units in parallel



With battery connected

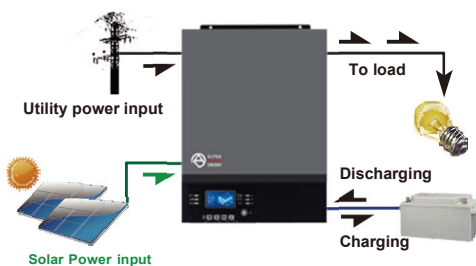

Without battery connected

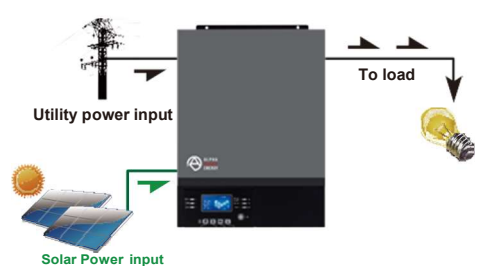



MODEL	SPCIII5-5000-48
Rated Power	5000VA/5000W
INPUT	
Voltage	230 VAC
Selectable Voltage Range	170-280 VAC (For Personal Computers) 90-280 VAC (For Home Appliances)
Frequency Range	50 Hz/60 Hz (Auto sensing)
OUTPUT	
AC Voltage Regulation (Batt. Mode)	230 VAC 3 5%
Overload capacity	100ms @ ≥200% load; 5s@≥150% load; 10s@110%~150% load;
Efficiency (Peak)	90 %
Transfer Time	15 ms (For Personal Computers) 20 ms (For Home Appliances)
Waveform	Pure sine wave
No Load Power Consumption	< 60W
BATTERY	
Battery Voltage	48 VDC
Floating Charge Voltage	54 VDC
Overcharge Protection	66 VDC
SOLAR CHARGER & AC CHARGER	
Solar Charger Type	MPPT
Maximum PV Array Power	5000 W
MPPT Range @ Operating Voltage	120 - 430 VDC
Maximum PV Array Open Circuit Voltage	450 VDC
PV Array Open Circuit Start Voltage	150 +/- 10 VDC
Maximum Solar Charge Current	100 A
Maximum AC Charge Current	100 A
Maximum Charge Current	100 A
PHYSICAL	
Dimension, D x W x H (mm)	140 x 295 x 468
Net Weight (kgs)	12.0
Communication Interface	USB, RS232, RS485, Bluetooth
ENVIRONMENT	
Humidity	5% to 95% Relative Humidity (Non-condensing)
Operating Temperature	-10°C to 50°C
Storage Temperature	-15°C to 60°C

All information contained in this document is subject to change without notice.



Worldwide Corporate Offices

Headquarter Germany

Hansastraße 8
D-91126 Schwabach
Tel: +49 9122 79889 0
Fax: +49 9122 79889 21
Mail: info@alpha-outback-energy.com

Eastern Europe

ee@alpha-outback-energy.com

Middle East

me@alpha-outback-energy.com

France and Benelux

fbnl@alpha-outback-energy.com

Spain

spain@alpha-outback-energy.com

Russia

russia@alpha-outback-energy.com

Africa

africa@alpha-outback-energy.com